

The Riverview

Plan# LTB0604



470 B. Leazer Road
Salisbury, NC 28147
(704) 638-0677
www.locktitelogs.com

Square Footage

First Floor:	800
Second Floor:	350
Optional Basement:	800
Porches:	598
Total Footage:	2548
Total Living Space:	1150

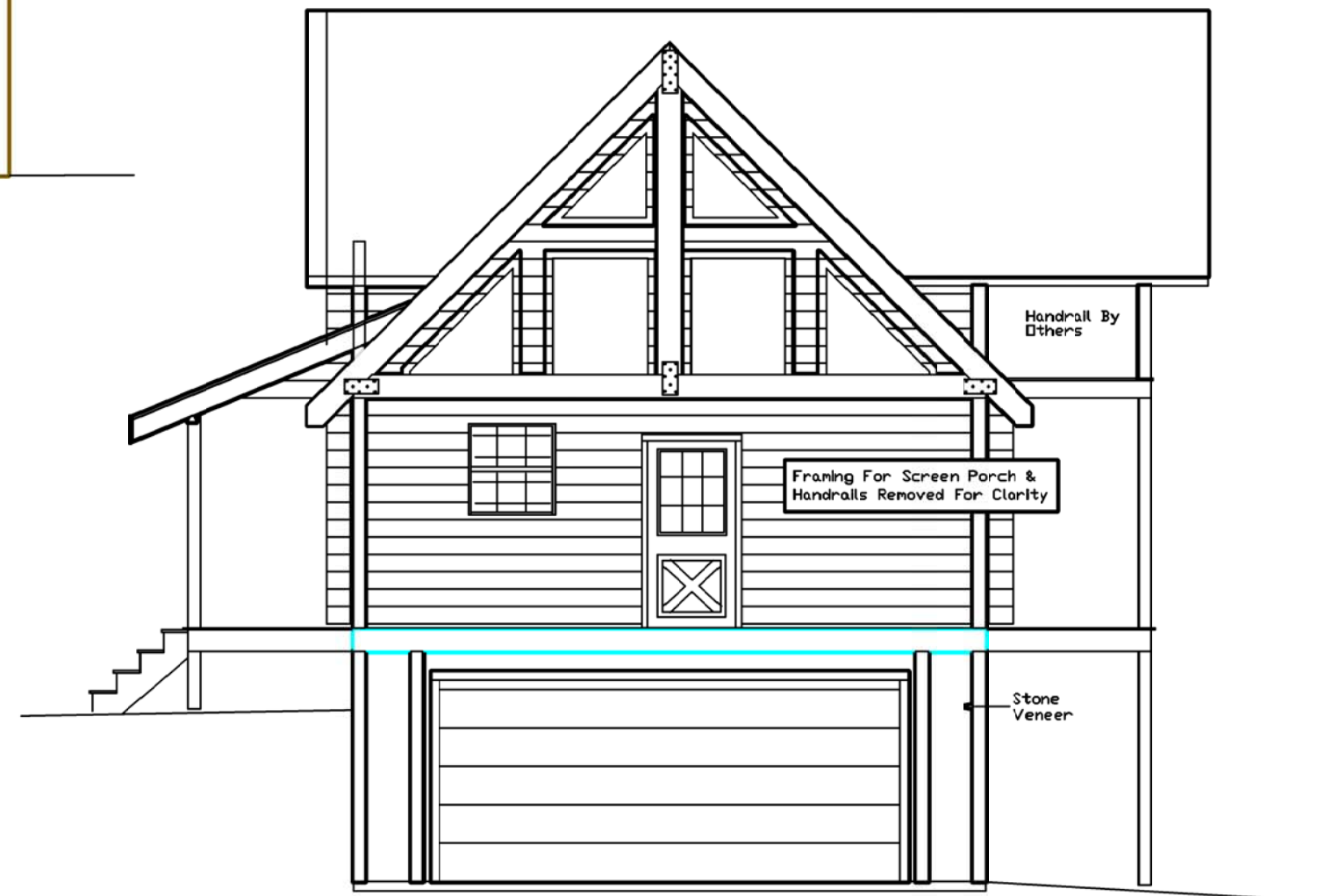

The Riverview

Plan# LTB0605

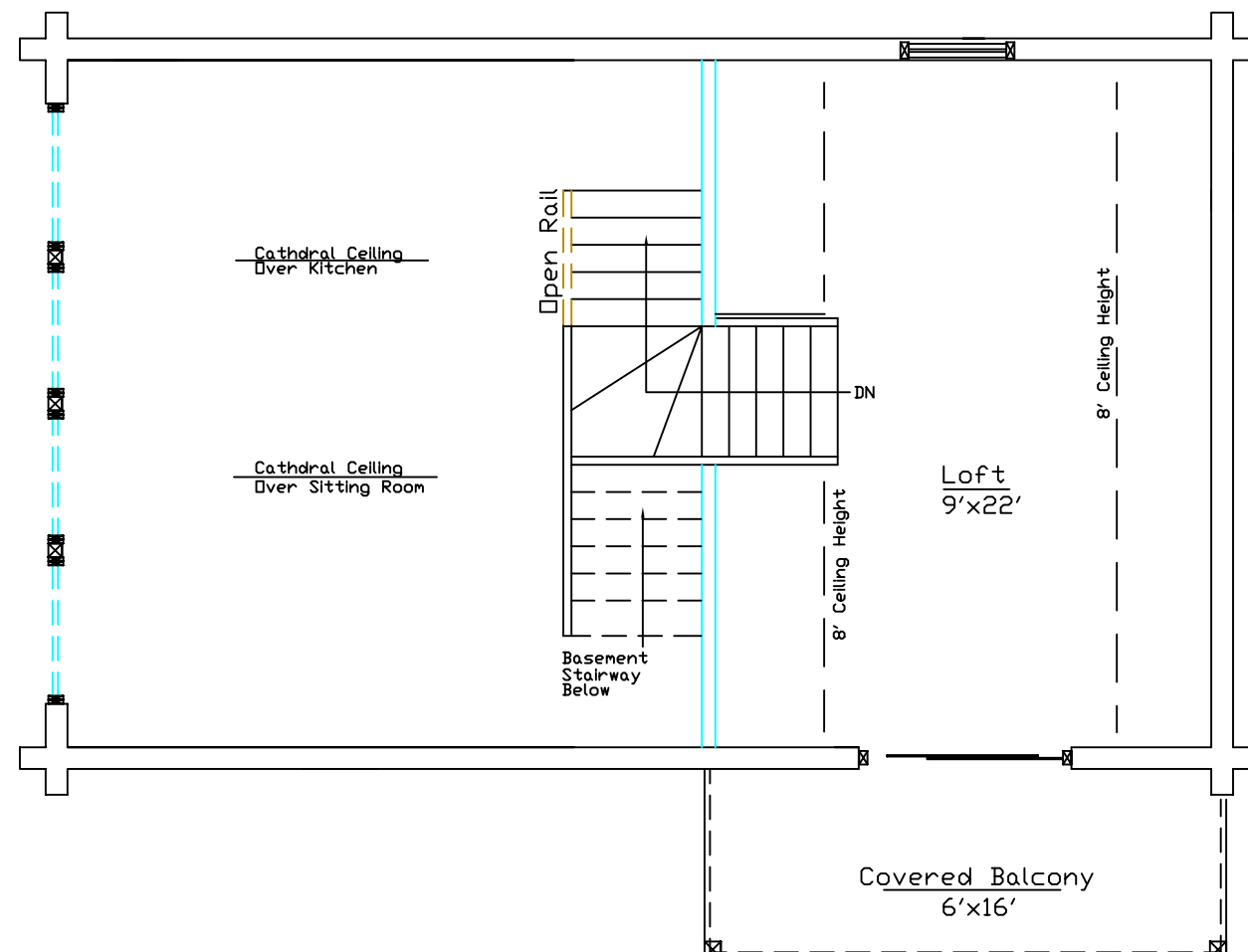
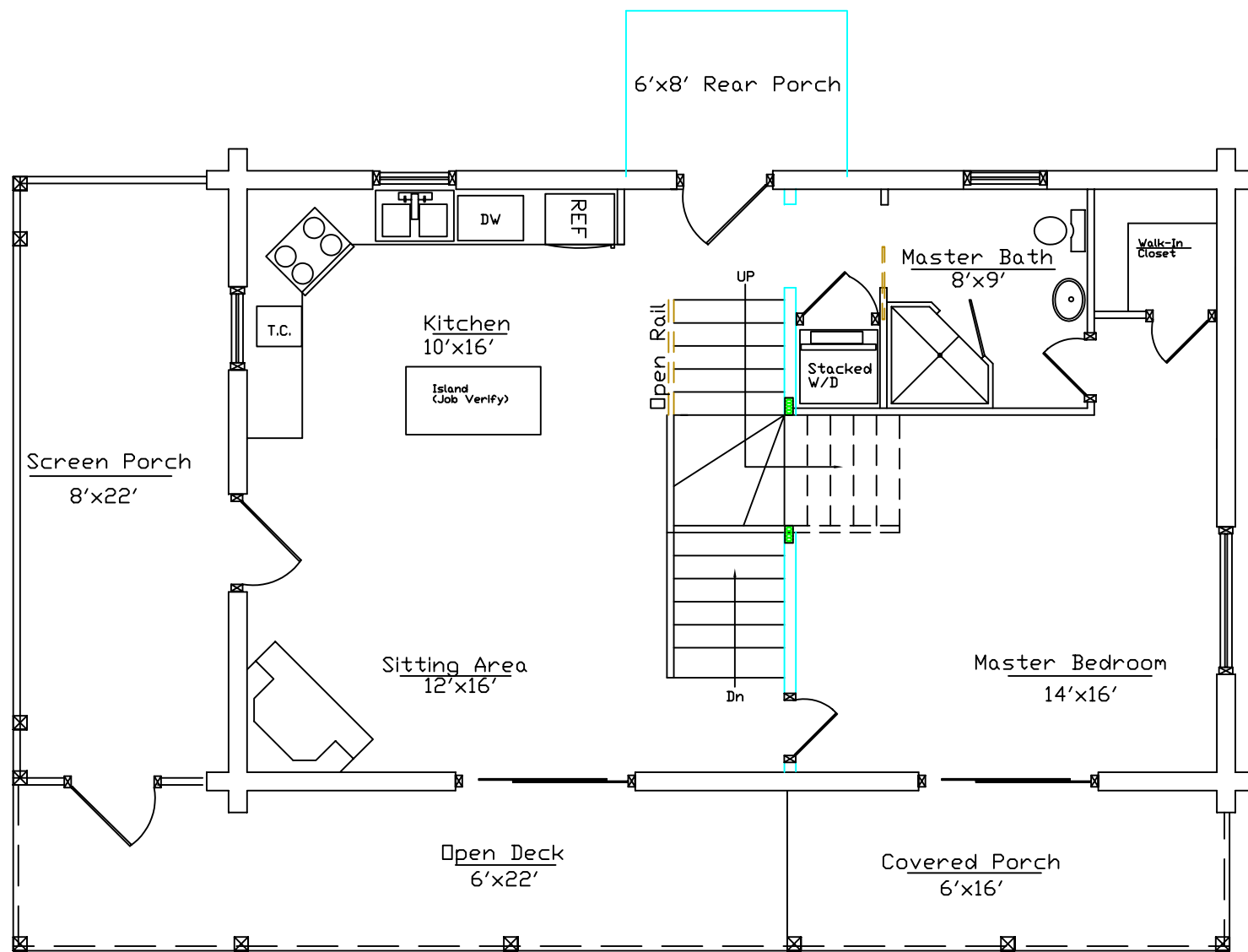

Precision Pre-Cut Log Kit Includes:

Precision Pre-Cut Logs

PVC Foam Seal

Log Fasteners

Sika-Flex 201 Adhesive

Pre-Cut Starter Plates

Pre-Cut Window & Door Jigs

Heavy Beam 2nd Floor System

Lightweight Frame Roof System

Wood Windows

Start-Up On Site Assistance Program

2x6 T&G Decking For 2nd Floor & Roof

